

IMMERSION™

LED Display Lighting

Refrigerated Vertical Cases
RV30 Series

a product of
ecomagination™



imagination at work

LED Lights

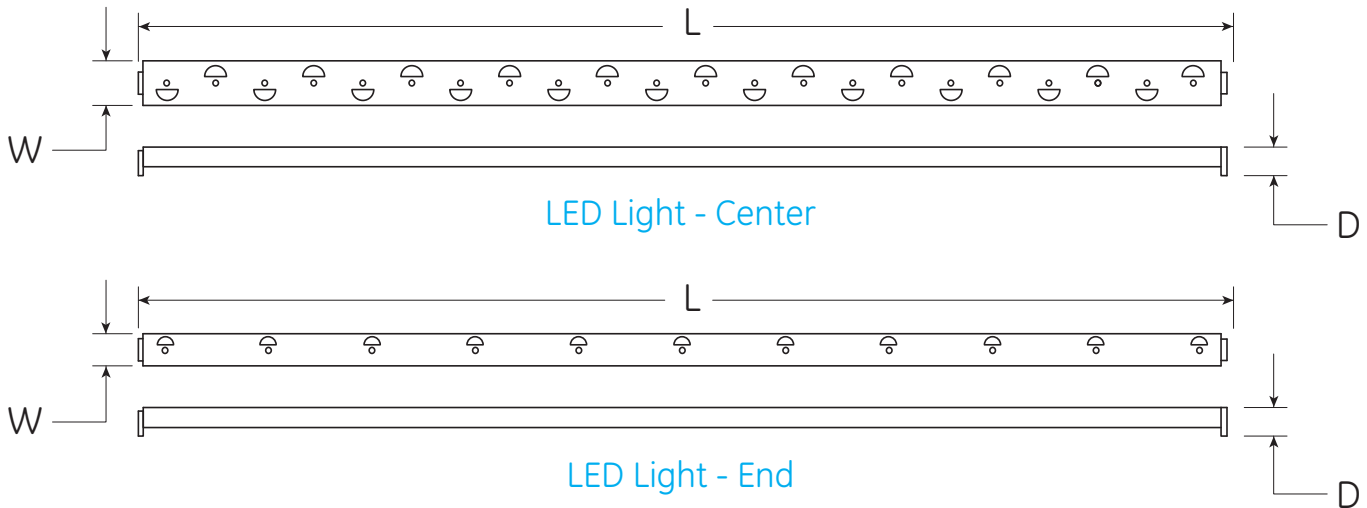

RV30 Series

	Product Code (Single)	Product Code (10-Pack)	Description	Item	Color Temp (K)*	Illuminance (Lux)**	PERFORMANCE DATA			DIMENSIONAL DATA			
							Life (Hours)	CRI (Typical)	Energy (Watts)	Length (L)	Width (W)	Depth (D)	
5000K	75955	75958	GE-LT303050CTR	30" LED Light - Center	5000	1500	50,000	70	12	(inch) 27.3 (mm) 693.4	3.3 84	1.1 28	
	75956	75959	GE-LT303050EDL	30" LED Light - Left End	5000	1500	50,000	70	7	(inch) 27.4 (mm) 696	2.3 58	1.2 30	
	75957	75960	GE-LT303050EDR	30" LED Light - Right End									
	78633	78914	GE-LT306050CTR	60" LED Light - Center	5000	1150	50,000	70	29	(inch) 57.6 (mm) 1463	3.3 84	1.1 28	
	78634	78915	GE-LT306050EDL	60" LED Light - Left End	5000	1150	50,000	70	14.5	(inch) 57.7 (mm) 1466	2.3 58	1.2 30	
	78913	78916	GE-LT306050EDR	60" LED Light - Right End									
	78966	78969	GE-LT307050CTR	70" LED Light - Center	5000	1150	50,000	70	34	(inch) 68 (mm) 1727	3.3 84	1.1 28	
	78967	78970	GE-LT307050EDL	70" LED Light - Left End	5000	1150	50,000	70	17	(inch) 68.1 (mm) 1730	2.3 58	1.2 30	
	78968	78971	GE-LT307050EDR	70" LED Light - Right End									
	4100K	75961	75968	GE-LT303041CTR	30" LED Light - Center	4100	1350	50,000	70	12	(inch) 27.3 (mm) 693.4	3.3 84	1.1 28
		75962	75969	GE-LT303041EDL	30" LED Light - Left End	4100	1350	50,000	70	7	(inch) 27.4 (mm) 696	2.3 58	1.2 30
		75967	75970	GE-LT303041EDR	30" LED Light - Right End								
78917		78980	GE-LT306041CTR	60" LED Light - Center	4100	1100	50,000	70	29	(inch) 57.6 (mm) 1463	3.3 84	1.1 28	
78918		78921	GE-LT306041EDL	60" LED Light - Left End	4100	1100	50,000	70	14.5	(inch) 57.7 (mm) 1466	2.3 58	1.2 30	
78919		78922	GE-LT306041EDR	60" LED Light - Right End									
78972		78975	GE-LT307041CTR	70" LED Light - Center	4100	1100	50,000	70	34	(inch) 68 (mm) 1727	3.3 84	1.1 28	
78973		78976	GE-LT307041EDL	70" LED Light - Left End	4100	1100	50,000	70	17	(inch) 68.1 (mm) 1730	2.3 58	1.2 30	
78974		78977	GE-LT307041EDR	70" LED Light - Right End									
3500K		78923	78926	GE-LT306035CTR	60" LED Light - Center	3500	1050	50,000	70	29	(inch) 57.6 (mm) 1463	3.3 84	1.1 28
	78924	78927	GE-LT306035EDL	60" LED Light - Left End	3500	1050	50,000	70	14.5	(inch) 57.7 (mm) 1466	2.3 58	1.2 30	
	78925	78928	GE-LT306035EDR	60" LED Light - Right End									
	78978	78981	GE-LT307035CTR	70" LED Light - Center	3500	1050	50,000	70	34	(inch) 68 (mm) 1727	3.3 84	1.1 28	
	78979	78982	GE-LT307035EDL	70" LED Light - Left End	3500	1050	50,000	70	17	(inch) 68.1 (mm) 1730	2.3 58	1.2 30	
	78980	78983	GE-LT307035EDR	70" LED Light - Right End									

*Color temp (CCT) +/- 10%

**Initial illuminance (lux) +/-15% based on typical in-store performance in an appropriately sized case. 30" lights measured at 3" throw; 60" and 70" lights measured at 6" throw.

Accessories

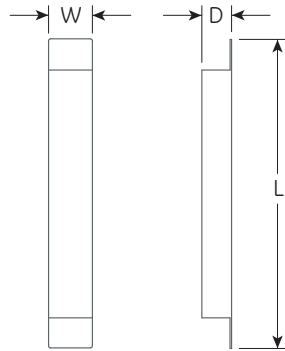

LED Driver

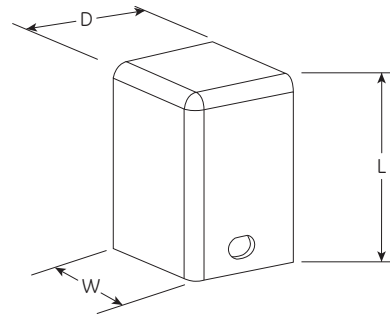

Wire Cover

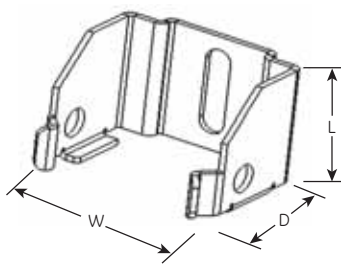

Center Mounting Clip

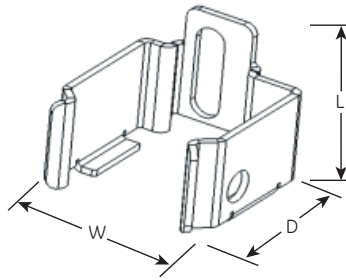

End Mounting Clip (ED1)

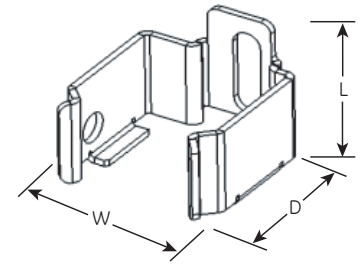

End Mounting Clip (ED2)

RV30 Series

Product Code	Description	Item	DIMENSIONAL DATA			
			Length (L)	Width (W)	Depth (D)	
78348	GE-PS1700NCMUL-SY	Constant Current LED Driver	(inch)	12.1	1.7	1.2
			(mm)	307	43	30
74915	GE080/G/V24T1-A	Constant Voltage LED Driver	(inch)	9.5	1.7	1.2
			(mm)	241	43	30
75971	GE-MC-LT3060CTR	Universal Mounting Clip - Center	(inch)	0.9	1.2	1.1
			(mm)	23	30	27
75972	GE-MC-LT3060ED1	Universal Mounting Clip - End #1	(inch)	0.9	1.0	1.0
			(mm)	23	25	25
75973	GE-MC-LT3060ED2	Universal Mounting Clip - End #2	(inch)	0.9	1.0	1.0
			(mm)	23	25	25
75974	GE-CV-LT3060CTR	Universal Wire Cover - Center and End	(inch)	1.6	1.3	1.0
			(mm)	41	33	25

LED Driver Performance Data

	78348 GE-PS1700NCMUL-SY			74915 GE080/G/V24T1-A		
	Min	Typical	Max	Min	Typical	Max
Input Voltage (VAC)	90	100/240	264	90	100/240	264
Input Current (A)	0.3	0.55	1.0	0.5	0.6	1.1
Input Line Frequency (Hz)	50/60			50/60		
30" Output Voltage (V)				24.25	25	25.75
60" Output Voltage (V)	40	43	46			
70" Output Voltage (V)	47	51	55			
Output Power (W)	80			80		
Max Output Current (A)	1.2			3.3		
Output Current for Dip Switch Test Mode (A) <i>(factory default)</i>	0.3			NA		
Output Current for Dip Switch Low (A) <i>(1 center light OR 1 end light set)</i>	0.6			NA		
Output Current for Dip Switch Medium (A) <i>(1 center light and 1 end light)</i>	0.9			NA		
Output Current for Dip Switch High (A) <i>(2 center lights OR 1 center light and 1 end light set)</i>	1.2			NA		
Total Harmonic Distortion	<20%			<20%		
Power Factor	>0.9	0.95		>0.9	0.95	
Operating Temperature Range (°C)	-40 C		40 C	-40 C	25 C	60 C
Storage Temperature Range (°C)	-40 C		85 C	-40 C		85 C

Conforms to the following standards:



E316082
SANITATION
NSF/ANSI 7

This device complies with Part 15 of the FCC Rules. Operation is subject to the following two conditions: (1) this device may not cause harmful interference, and (2) this device must accept any interference received, including interference that may cause undesired operation.

This Class [A] RFLD complies with the Canadian standard ICES-005. Ce DEFR de la classe [A] est conforme à la NMB-005 du Canada.



6180 Halle Drive • Valley View, Ohio 44125-4635 • USA
P: 216.606.6555 • F: 216.606.6599 • www.lumination.com • info@lumination.com

For customer service & technical support, contact:
1-888-MY-GE-LED (1.888.694.3533)

Lumination, LLC is a subsidiary of the General Electric Company. Immersion is a trademark of Lumination, LLC. The GE brand and logo are trademarks of the General Electric Company. © 2008 Lumination, LLC. Information provided is subject to change without notice. All values are design or typical values when measured under laboratory conditions.